



**COUNTY
LEADERS**

NOV. 14-16

HYATT REGENCY
LAKE WASHINGTON

KING COUNTY

HOSTED BY **WASHINGTON STATE
ASSOCIATION of COUNTIES**

2022 COUNTY LEADERS CONFERENCE

WORKING TOGETHER

**P
R
O
G
R
A
M
G
U
I
D
E**

TABLE OF CONTENTS

General Information 3

Conference Map 4

Agenda 6

Affiliate Agenda..... 14

WSAC Officers and Staff 22

Sponsor Directory..... 23

County Supporters 26

Exhibitors Directory..... 27

**DOWNLOAD
OUR MOBILE
CONFERENCE
APPLICATION**



Get **Whova** from the App Store or Google Play.
Please sign up for the app with your **social media account or email.**

- View Professional Profiles** ✓
- Network with Attendees** ✓
- Notification Updates** ✓
- Event Agenda** ✓

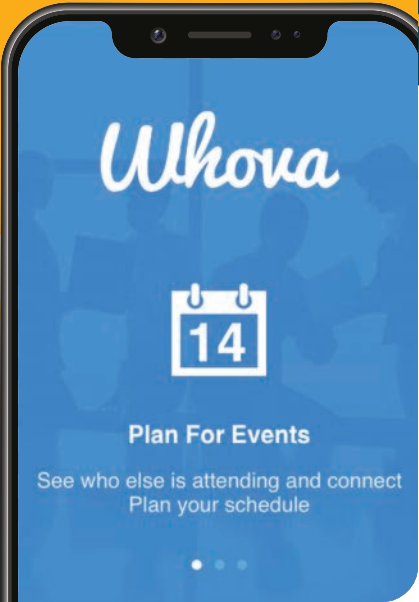

General Information



STAY CONNECTED!

Network Name: Hyatt_Meeting

Password: CountyLeaders2022



PARKING RATES

Register your vehicle at check-in if staying at the Hyatt. Ask for a parking permit at the conference registration desk if not staying at the Hyatt.



REGISTRATION

Attendance for a full day or the entire conference, which includes meals and social events, requires registration to offset production costs. Individual meals are not available for purchase.

Please see the Information & Registration table located on the first floor for assistance.



NAME BADGES

Wearing a name badge is very helpful to not just those working at the conference, but also your peers. Please be sure to keep your badge on at all times. Your name badge serves as your meal ticket. Don't go hungry because you are too cool to wear a badge.



PHOTOGRAPHY, LOCAL MEDIA & OBSERVERS

Please be aware that guests and photographers may be in the room for any session, meeting or general event.

Conference Map

MEETING SPACES

PUBLIC SPACE

★

REGISTRATION

◆

EXHIBIT HALL

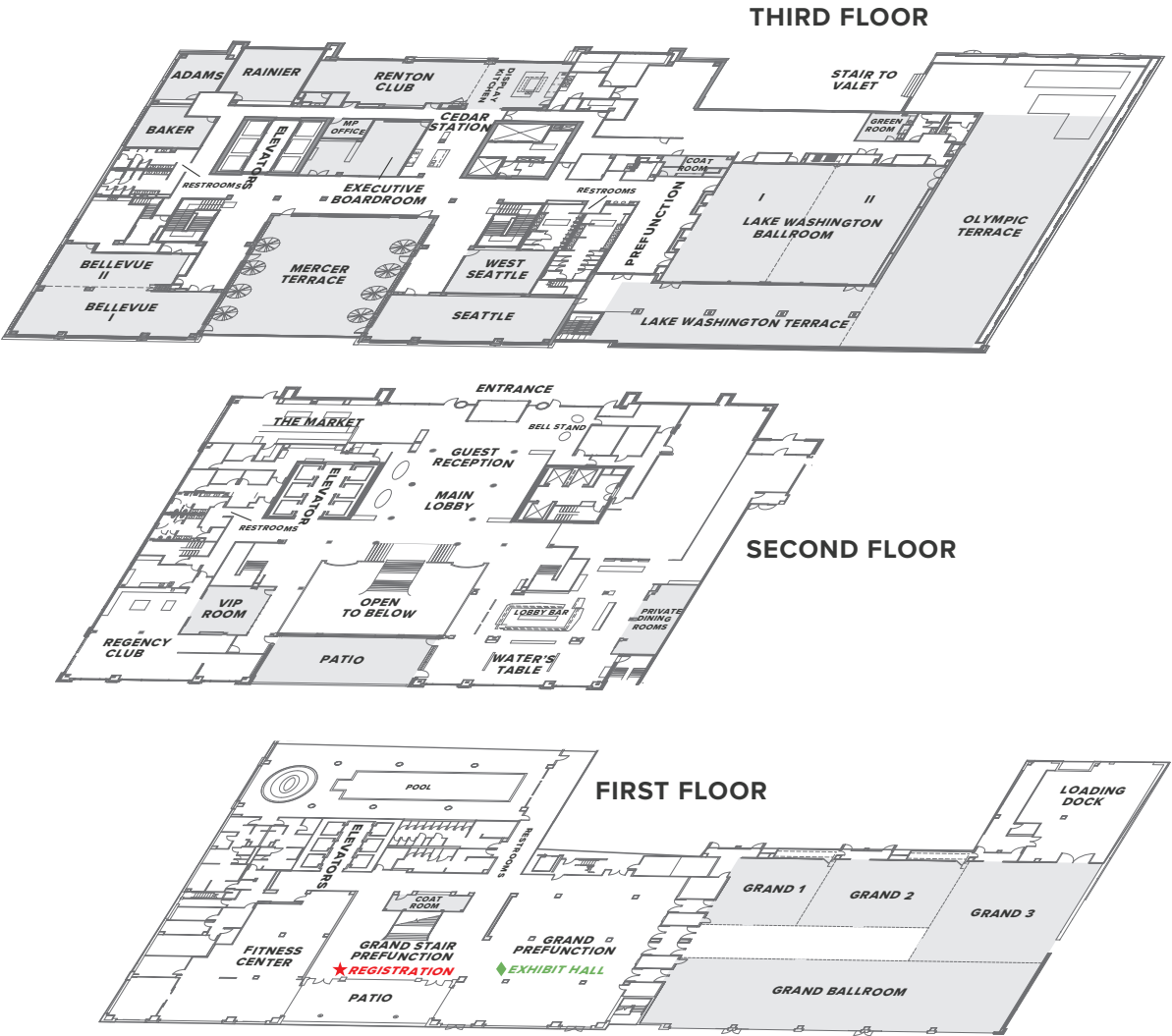

EXHIBITOR HOURS

Tuesday, Nov. 15

7:00am - 5:00pm

Wednesday, Nov. 16

7:00am - 2:30pm

SPONSORS & EXHIBITORS

- Department of Commerce
- FORWARD
- WCIF
- WM (Waste Management)
- ESD Shared Work
- Republic Services
- WRRRA
- Waste Connections
- Gordon Thomas Honeywell
- MRSC
- WRCIP (ChooseClear)
- AWC
- CivicPlus
- Emergent BioSolutions
- Restorical
- Nationwide
- Enterprise Fleet Management
- NACo
- cashVest by three+one
- Beacon Economics
- BuyBoard
- VSP
- Labor & Industries
- StructureCraft
- USDA Rural Development
- WASPC COS
- PaintCare
- InQuik Bridging Systems
- Rentacrate

Win Prizes! Join these Contests!



EXHIBITION PASSPORT

Grab your passport at the registration table and visit all our Exhibitors for a stamp. Once you get every square stamped, turn your completed passport into the registration desk **by end of lunch on Wednesday** to be entered into a raffle for some awesome prizes! Prizes will be awarded at the Closing Reception.



WHOVA LEADERBOARD

Earn points based on your participation in the community board in our conference app, Whova. Download it now to start earning points! Interact the most and earn prizes at our Closing Reception. **The deadline to earn points is end of lunch on Wednesday.**



CAN YOU SPOT THE SQUATCH?

Believe it or not, 10 Squatches are hiding on the walls around the conference. Scan the QR code, enter your info, and you'll be entered into the prize drawings (see the conference app for prize details)! Each Squatch you scan is another entry (up to 10 per attendee)! **Deadline to enter is the end of lunch on Wednesday.**

Agenda

Monday, November 14

7:00am - 5:00pm	Registration & Information Center	Grand Stair
8:00am - 9:50am	Timber and Public Lands Counties Caucus	Grand 3
10:00am - 12:00pm	Columbia River Caucus Quarterly Meeting	Rainier
11:00am - 12:30pm	Lunch	Grand Ballroom
1:00pm - 5:00pm	WSALPHO Affiliate Meeting	Bellevue
1:00pm - 5:00pm	WACSWM Affiliate Meeting	West Seattle
1:00pm - 5:30pm	WSACE Business Meeting	Grand 1
12:00pm - 3:00pm	WSAC - Board of Directors Meeting	Grand 3
3:00pm - 5:00pm	WCAA Affiliate Meeting	Rainier
3:15pm - 6:00pm	WSAC - Legislative Steering Committee Meeting	Grand 3
5:00pm - 7:00pm	Opening Reception (Sponsored by Forward)	Seattle
7:00pm - 8:30pm	Bingo Night (Sponsored by Gordon Thomas Honeywell) .	Bellevue
7:00pm - 9:30pm	Hospitality Suite	Presidential Suite - Room 861
	Located on private floor. Visit WHOVA for info on access.	

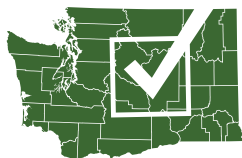

WSAC Elections | 2022

Have you cast your ballot for the WSAC Board of Directors?

See your “Vote Now” email for a link to your ballot.
Visit the Registration and Information Center if you
need help casting your ballot.

Polls Close Tuesday Nov. 15 at 1:00pm



November 14 - 16, 2023

SAVE THE DATE

The Davenport Grand | Spokane County

HOSTED BY **WASHINGTON STATE
ASSOCIATION of COUNTIES**

WSAC AFFILIATES — KNOW YOUR ACRONYMS

ACHS

Association of County
Human Services

WACSWM

Washington Association of
County Solid Waste Managers

WCAA

Washington County
Administration Association

WSAC

Washington State
Association of Counties

WSACE

Washington State Association
of County Engineers

WSACRPD

Washington State Association
of County and Regional
Planning Directors

WSALPHO

Washington State
Association of Local
Public Health Officials

Agenda

Tuesday, November 15

7:00am - 5:00pm	Registration & Information Center	Grand Stair
7:00am - 5:00pm	Exhibition	Grand Prefunction
7:00am - 8:15am	Breakfast	Grand Ballroom
	Newly Elected (2020-22) will have Reserved Tables in Grand Ballroom	
8:15am - 9:30am	Opening General Session - Bridging Divides in a Polarized World.	Lake Washington Ballroom

ABOUT THIS SESSION

MEET YOUR SPEAKER



Bill Doherty, PhD
Braver Angels

We may live in the most polarized time since the 1850s. It's not mainly about issues but about how we regard and treat people who differ from us politically. We seem to be losing our collective ability to disagree without hostility and find solutions to practical problems. The good news is that most Americans agree we are too polarized and they are supporting grass roots initiatives to bridge divides. This presentation will address sources of polarization and suggest tools that county commissioners can employ to lower the temperature of disputes and find common ground solutions.

8:15am - 9:00am	WSALPHO BOD Meeting	Bellevue
9:00am - 12:00pm	WSALPHO Affiliate Meeting.	Bellevue
9:30am - 5:00pm	WACSWM Affiliate Meeting	West Seattle
9:45am - 5:00pm	WSACE Affiliate Meeting & Optional King County Tour. . . .	Grand 1
9:30am - 9:45am	Networking Break.	Grand Prefunction
9:45am - 12:00pm	Braver Angels Breakout - Managing Difficult Conversations with Constituents	Seattle

William J. Doherty, Ph.D, Co-Founder, Braver Angels

Elected officials have always dealt with constituents and colleagues who disagree and sometimes become disagreeable. But with polarization and incivility rising everywhere, new skills are required for public leaders who want to survive in their job, enjoy it, and make a difference for their community. This workshop will equip you with practical tools you can use immediately when a constituent or colleague (of whatever political party) tells you how wrong you are and how you should change course. These skills can lower stress that comes from having difficult political conversations and help you feel more satisfied and more confident in your role as an elected official. At best, you will soften critics and find more common ground. Or at least you won't add fuel to today's epidemic of incivility.

[Tuesday Agenda Continued →](#)

Agenda

9:45am - 10:45am	<p>Toward a Resilient Puget Sound - A New Plan and New Funding Renton Club</p> <p>Wren McNally, Environmental Planner, Puget Sound Partnership Jennifer Griffiths, Habitat Strategic Initiative Policy Lead, Washington Department of Fish and Wildlife Larry Epstein, Deputy Director, Puget Sound Partnership Kathleen Pozarycki, Senior Planner 2, Snohomish County</p> <p>Though it may appear pristine from a distance, Puget Sound is in serious trouble. Yet, Puget Sound can be a resilient ecosystem that supports healthy and diverse human communities, and the habitats and species that we care about and rely upon. Our decisions and policies concerning population growth, changing climate and ocean conditions, governance, public perceptions, economic factors, environmental justice, and other forces will drive how the region changes and, ultimately, the wellbeing of the people who are inextricably connected to the health of Puget Sound. The recently updated 2022-2026 Action Agenda charts the course for Puget Sound recovery. It presents the most effective and beneficial strategies, and actions for Puget Sound recovery and resilience, supported by science and robust partner engagement. This session will provide an introduction to the Action Agenda for Puget Sound, describe the Puget Sound Partnership's collaborative problem-solving forums available to county leaders, and provide information about funding opportunities to support Puget Sound recovery projects.</p>
9:45am - 10:45am	<p>Washington Balance of State Continuum of Care Grand 2</p> <p>Nick Mondau, Data Systems Manager, Department of Commerce</p> <p>Washington's Balance of State Continuum of Care is a large federal funding source of homeless housing programs that is available to rural counties in Washington State. Learn about how your community can access this funding source to add housing resources to your community.</p>
10:45am - 11:00am	<p>Networking Break Grand Prefunction</p>
11:00am - 12:00pm	<p>ARPA Roundtable Grand 2</p> <p>Facilitated by Curtis Steinhauer, Policy Analyst, WSAC</p> <p>Roundtable discussion on American Rescue Plan State and Local Fiscal Recovery Fund projects. Session will include a short presentation from WSAC staff followed by a Q&A and County share-out of interesting projects.</p>
11:00am - 12:00pm	<p>JTC County Engineer Panel Grand 3</p> <p>Axel Swanson, Managing Director, WSAC</p> <p>The Joint Transportation Committee (JTC) is a bipartisan, bicameral legislative agency governed by the Chairs and Ranking Members of the House and Senate Transportation Committees. The JTC has traditionally held their November meeting in conjunction with the County Leaders Conference to give the Washington State Association of County Engineers (WSACE) an opportunity to provide an update on the county transportation system. Join your colleagues for an update from WSACE and a dialogue with County Engineers regarding the challenges of funding county transportation needs within the current uncertain economic times.</p>
12:00pm - 1:15pm	<p>County Awards Luncheon (Sponsored by WCIF) . . Grand Ballroom</p>
12:00pm - 1:15pm	<p>JTC/WSACE Lunch Grand 1</p>

Agenda

1:15pm - 2:15pm

General Session - Childhood Trauma, Resilience, and Redemption. Lake Washington Ballroom

ABOUT THIS SESSION

MEET YOUR SPEAKER



Derek Clark
Keynote Speaker

Derek will give you insight into his personal childhood journey of being wrongfully labeled in the foster care system for thirteen years, and the key reasons on how he did not turn out addicted, incarcerated, or dead. Derek will challenge many of the accepted practices of the child welfare system and provide alternative ways to understand why kids behave in the ways that they do. This understanding will generate hope and restore dignity to the young people as well as restore humanness and compassion in the hearts of professionals.

VIEW WHOVA APP FOR MORE INFO

2:15pm - 2:30pm

Networking Break. Grand Prefunction

2:30pm - 3:30pm

ACES Panel. Seattle

Derek Clark, Keynote Speaker

Jennifer Sass-Walton, RN, BSN, Child & Family Health manager, Skagit County Public Health

Naomi Wilson, Community Assessment Manager, Tacoma-Pierce County Health Department

Adverse Childhood Experiences (ACEs) refer to different types of adversity children face in the home environment; abuse, neglect, and dysfunction.

A panel featuring our guest speaker, Derek Clark, and two local health professionals will discuss how some counties are currently working to address ACEs through early childhood programs as well as other considerations in building larger statewide support for families and children living with toxic stress.

2:30pm - 3:30pm

Polarization & Incivility in Politics: Local Government's Path Forward Grand 2

Francis Benjamin, Information Systems Coordinator, Washington State University

Political polarization and incivility are having a deleterious impact on all levels of government, including local government which is traditionally viewed as non-partisan. This session will examine the history of political polarization and incivility to provide context to how we got to this point, and highlight what challenges stand before us. Working from over a decade of political civility research, I will examine different styles of incivility, their relationship to diversity, equity, and inclusiveness, and how incivility is affecting governmental processes. I will apply a local government lens to look at the interactions between the elected, staff and community members and will identify best practices and recommended strategies to move forward.

Tuesday Agenda Continued →

Agenda

2:30pm - 3:30pm	Hot Topics in Land Use Renton Club Darren Carnell, Senior Prosecuting Attorney, King County This session addresses current issues in land use and environmental law. The presentation will include a summary of recent state and federal judicial and administrative decisions, as well as recently adopted legislation. Significant attention will be given to the context in which these legal developments have occurred and what attendees should watch for in the coming year. Understanding the context of particular decisions will help county leaders accomplish policy objectives while limiting litigation risk. Additionally, the presentation will address pending agency rulemaking and legislation likely coming in 2022 and identify themes and trends that will affect legal development in coming years.
3:30pm - 3:45pm	Networking Break. Grand Prefunction
3:45pm - 4:45pm	Growing Talent at the Community Level. Renton Club Michael Meotti, Executive Director, Washington Student Achievement Council Kimber Connors, Executive Director, Washington State Opportunity Scholarship The state can support talent development, but ultimately the education and training opportunities accessible for most Washington residents are in the same community where they live, work and study. Learn about the innovative Regional Challenge Grant program launched by the Washington Student Achievement Council to fund community partnerships that support college and career development that opens these pathways to all. Hear from the Washington State Opportunity Scholarship program that can match local fundraising to supplement our state's generous financial aid programs for targeted purposes. Both organizations can work with county governments as they strive to develop talent and opportunity for local residents.
3:45pm - 4:45pm	Cybersecurity Awareness for Leaders. Grand 2 Daniel Mann, Cybersecurity Specialist, Washington State Auditor's Office From phishing to ransomware and data breaches, local governments are increasingly becoming victims of more sophisticated, and complex cyberattacks. And the amount of damage these attacks cause is growing too. In this session, we'll take a look at what hackers want from your county and how they're evolving their attacks to get it. Then we'll take a dive into the role of leadership in strengthening your county's cybersecurity program with adequate resources, training, policies and more.
3:45pm - 4:45pm	FPHS Update and Roundtable for Elected officials Seattle Jamie Bodden, MPH, MSW, Managing Director, WSALPHO Foundational Public Health Services had an extremely successful 22-23 biennium, receiving \$175 M in the State's Operating Budget. Yet, our work to rebuild and transform public health continues. Join WSALPHO, local health jurisdictions, and other local elected officials to hear an update on current FPHS efforts, and what's happening during 2023 Legislative Session and beyond. We'll also provide some time for questions for elected officials that are new to FPHS efforts.
6:30pm - 8:30pm	Top Golf (Sponsored by Republic Services) Front of Hyatt Transportation Provided by Starline Luxury Coaches. Meet in front of the Hyatt 5 minutes before the following wave times: 5:45pm 6:05pm 6:25pm <i>We will begin return trips around 8:00pm.</i>
8:00pm - 9:30pm	Hospitality Suite Presidential Suite - Room 861 Located on private floor. Visit WHOVA for info on access.

Agenda

Wednesday, November 16

7:00am - 5:00pm	Registration & Information Center Grand Stair
7:00am - 2:30pm	Exhibition Grand Prefunction
7:00am - 8:30am	Breakfast Grand Ballroom
7:00am - 8:00am	SWISS Breakfast Grand 1
8:00am - 9:35am	WSAC General Membership Meeting Grand 3
8:30am - 2:15pm	WSACE Meetings Grand 1
9:30am - 9:45am	Networking Break Grand Prefunction
9:00am - 12:00pm	WSACRPD Affiliate Meeting West Seattle
10:00am - 12:00pm	Counties Coastal Caucus Meeting Rainier
9:45am - 10:45am	Road Usage Charge Update Grand 2 Travis Dunn, Vice President, CDM Smith The Washington State Transportation Commission has been researching road usage charging as a possible future revenue mechanism to replace fuel taxes and EV registration surcharges. The presentation will provide an update on recent research findings related to equity impacts of road usage charging and efforts to improve the user experience and reduce the cost of collection.
9:45am - 10:45am	Advancing Plastics Circularity Renton Club Pete Keller, Vice President, Recycling & Sustainability, Republic Services Most materials that go into the recycling bin are turned back into a similar type of packaging. Unfortunately, that hasn't been the case with plastics, which often are downcycled into products like clothing, carpet, or construction piping. Additionally, consumer brands have set ambitious targets to use more post-consumer content in their packaging, but the current supply of recycled plastics falls short. However, new advancements in circularity can help keep valuable materials in the circular economy for the long term.
9:45am - 10:45am	Update on State Cannabis Seattle Rick Garza, Agency Director, Washington State Liquor and Cannabis Board Learn about current and emerging issues involving state regulators and the cannabis industry including enforcement and education data.
10:45am - 11:00am	Networking Break Grand Prefunction
11:00am - 12:00pm	Broadband Funding Opportunities Panel Grand 2 Mark Vasconi, Director, Washington State Broadband Office Sheila Richardson, Broadband Manager, Public Works Board Recent legislation at the state and federal level has dedicated millions of dollars toward the accelerated deployment and improvement of broadband infrastructure and service across our state. Come and hear from the State Broadband Office and the Public Works Board about what is happening at their agencies regarding broadband funding opportunities for your county. Get the most current information about broadband grants and an update for what to expect in 2023 and beyond.

Wednesday Agenda Continued →

Agenda

11:00am - 12:00pm	<p>The Benefit of Community-Based Strategic Planning Renton Club</p> <p>Mackey Smith, Head of Strategy Consulting & Planning, Tanner LLC Erik Martin, County Manager, Lewis County</p> <p>Be empowered with the tools necessary to tap into the hearts and minds of citizens, re-engaging them in community visioning. Specifically, learn about the differences between community-based strategic planning and other plans, the anatomy of a community-based plan, and effective techniques for engaging citizens in the planning process, especially in a post-pandemic world where community engagement looks quite different than it did a few short years ago. Attendees will learn how to take what citizens are saying and synthesize that input into clear directives for their organization and ensure that their plan survives changes in staff or leadership and is implemented effectively so it doesn't just sit on the shelf. This training will also cover how to apply these principles to other, more targeted community initiatives, such as policing, population growth, economic development, and other crucial, and at times contentious, topics. <i>This session is open to all, but best suited for Elected Officials and Administrative Executive Leadership.</i></p>
11:00am - 12:00pm	<p>Federal Fund Exchange Pilot Program Panel. Seattle</p> <p>Jay Drye, Director, WSDOT Local programs Todd O'Brien, Public Works Director, Adams County</p> <p>Federal transportation dollars are vital to the success of any county road fund. However, federal funds often come with added requirements, resulting in heftier price-tags and longer timelines. Tracking the success of federal fund exchange programs in other states, WSAC is advocating for a program in Washington, allowing counties to swap their suballocation of federal-aid highway funds for state transportation dollars. Come and hear subject matter experts explain the challenges federal funds present at the local level, the mechanics of how an exchange would work, and the benefits it could provide.</p>
12:00pm - 1:15pm	<p>Member Recognition Luncheon (Blitz). Grand Ballroom</p>
1:15pm - 2:15pm	<p>Broadband Partnerships Panel Grand 2</p> <p>Michael Gaffney, Assistant Director, WSU Extension Mark Ozias, Commissioner, Clallam County Scott Hutsell, Commissioner, Lincoln County Sam Low, Councilmember, Snohomish County</p> <p>Broadband service is delivered throughout our state in a variety of ways utilizing unique regional approaches and different partnerships. Come and hear from your colleagues about how they are taking advantage of newly available financial resources to accelerate broadband deployment in their communities. WSU extension will moderate a discussion with county leaders as they describe their approach to broadband deployment; the successes they are having, and the challenges they have faced.</p>
1:15pm - 2:15pm	<p>Behavioral Health Data Gaps. Seattle</p> <p>Cassie Lentz, Healthy Places Division Manager, Grays Harbor County Vickie Raines, Commissioner, Grays Harbor County</p> <p>What information do local decision makers need to address Behavioral Health systems in their communities? Presentation will include an overview of the current Behavioral Health system in Washington State and gaps in data. Information will center around current NACO initiative "Familiar Faces" which seeks innovative solutions to data gaps across Behavioral Health, Housing, and Law Enforcement.</p>

Agenda

1:15pm - 2:15pm

A Look Ahead to the Future of the GMA Renton Club

Clay White, Director of Planning, LDC Inc.

John Flanagan, Senior Policy Advisor, Office of Governor Jay Inslee

Dave Andersen, Managing Director, AICP

The Road Map to Washington's Future is an ongoing statewide collaborative conversation that has resulted in the reforms to planning laws and practice needed to modernize the states land use planning laws. Phase three of this process is wrapping up and the results of the two year process will be transmitted to the legislature in November. The process involved multiple stakeholders, with additional outreach to traditionally under represented communities and outreach to Washington's tribes. Major topics in play include: a review of annexation methods and incentives; the role of special districts; integration of environmental justice and equity considerations; elimination of overlaps and inefficiencies in the planning framework; a review of varied planning requirements and local government capacity; human health and wellbeing. In addition to this effort, reforms to address salmon recovery, climate change and the state's housing crisis are also underway. In this session the facilitators and project managers will present the results of the process, review how the task force developed the recommendations and discuss what to expect in the coming legislative session and beyond. Policy staff from the Governor's office will outline the Governor's strategy on critical issues such as housing, salmon recovery and climate change.

2:15pm - 2:30pm

Networking Break Grand Prefunction

2:30pm - 3:30pm

General Session - Navigating the

Stimulus Hangover Grand Ballroom

ABOUT THIS SESSION

MEET YOUR SPEAKER



**Dr. Chris
Thornberg**

Beacon Economics

Today, Federal Reserve policy is shifting, consumer unrest is spiking, and the public narrative is spinning rapidly. We are recovering from a stimulus hang-over, and the long reaching effects of overzealous quantitative easing. Understanding the economic conditions in the state and its regions provides valuable intelligence that helps you make decisions and set financial objectives for your county. Dr. Christopher Thornberg, Founding Partner of Beacon Economics, will deliver his singular insight and narrative context in this data-rich outlook presentation. He will showcase state and regional trends to help you forecast and prepare for future changes.

3:30pm - 4:30pm

Closing Reception (Food & Prizes!) Grand Ballroom

Affiliate Agenda

TCC

Timber Counties Caucus

Timber Counties Caucus

Monday, November 14

8:00am - 8:05am	Call to Order, Welcome, Introductions & Approval of the Agenda Grand 3
8:05am - 8:10am	Approval of minutes from 9/15/22
8:10am - 8:40am	Update from NACo on National Public Lands Issues
8:40am - 9:30am	Proposal for a Forest Carbon Project on Operable Forested State Trust Lands In Western Washington
9:30am - 9:50am	Roundtable Discussion
9:50am	Meeting Adjournment

CRCC

Columbia River Counties Caucus

Columbia River Counties Caucus

Monday, November 14

10:00am - 10:05am	Call to Order, Welcome, Introductions & Approval of the Agenda Rainier
10:05am - 10:10am	Approval of the minutes from 3/17/22 and 5/26/22
10:10am - 10:20am	Staff Updates
10:20am - 10:45am	Update – Office of Columbia River Operations And Projects, Legislative Update, Budget, Pasco Groundwater Rule Making
10:45am - 11:45am	Megadrought: The Colorado River Water Crisis
11:45am - 12:00pm	Roundtable Discussion
12:00pm	Meeting Adjournment



Washington State
Department of
Commerce

Our mission

The Washington State Department of Commerce's mission is to grow and improve jobs in Washington State by championing thriving communities, a prosperous economy, and sustainable infrastructure. We help strengthen communities by bringing together people and resources.

We strengthen communities

Housing
Infrastructure
Energy
Community Service
Planning
Community Facilities
Crime Victims Safety
Business Assistance

www.commerce.wa.gov



HOUSING
HOMELESSNESS



BUSINESS
ASSISTANCE

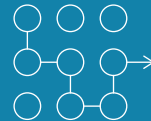

PLANNING



CRIME VICTIMS
SAFETY



INFRASTRUCTURE



ENERGY



COMMUNITY
FACILITIES



COMMUNITY
SERVICE



Affiliate Agenda

WACSWM
Washington Association of
County Solid Waste Managers

Washington Association of County
Solid Waste Managers

Monday, November 14

1:00pm - 1:30pm	Welcome and Warm Up West Seattle
1:30pm - 1:45pm	Meeting Overview
1:45pm - 2:30pm	Officer Elections
2:30pm - 3:00pm	Strategic Plan Report
3:00pm - 3:15pm	Networking Break Grand Prefunction
3:15pm - 4:15pm	Funding Study Presentation
4:15pm - 4:45pm	Work Group Updates
4:45pm - 5:00pm	Closing
5:00pm	Adjourn
6:00pm - 8:30pm	Member Dinner

Tuesday, November 15

9:30am - 10:00am	Monday Recap and Meeting Overview West Seattle
10:00am - 11:00am	Landfill Mining Presentation
11:00am - 11:15am	Networking Break Grand Prefunction
11:15am - 12:00pm	Legislative Priorities
1:30pm - 2:45pm	System Resiliency Workshop
3:00pm - 3:30pm	HHW EPR
3:30pm - 3:45pm	Networking Break Grand Prefunction
3:45pm - 4:45pm	County Networking
5:00pm	Adjourn



Republic Services is partnering with customers to create a more sustainable world.

With the recent acquisition of US Ecology, Republic Services can now offer our customers the broadest set of environmental solutions products and services available. As a leader in sustainability and innovation, we operate 77 renewable energy projects, are working on fleet electrification and are opening the nation's first integrated plastics recycling facility in 2023.



Sustainability in Action

Delivering Answers To Local Government Since 2007

Economic Development Strategies
Public Revenue Forecasting
Workforce and Policy Analysis
ARPA Services

beaconecon.com

info@beaconecon.com



FORWARD

The **FORWARD** Platform is an **Integrated Program Administration** solution that streamlines all essential components, people, and technology into a single workflow to effectively, securely, and equitably administer critical resources to help communities thrive.



QUICK

- We launch programs fast and accurately!
- Program operational and able to deploy in weeks, not months



ACCURATE

- 1,000s of applications processed with 0 errors
- Real time reporting & custom dashboards available 24/7



COST-EFFECTIVE

- No setup fees
- No monthly subscription
- Fees as low as 7%

WA County Leaders **FORWARD**!

Learn about FORWARD's impact in Washington State and how Integrated Program Administration can support your community.

www.forwardplatform.com/wacountyleaders



"FORWARD as a back office superpower has been invaluable, especially when it comes to assistance programs."

Martha Chaudhry
Special Project, Economic Development
City of Kirkland, WA

FORWARD administered over \$300,000 to small businesses through the City of Kirkland ARPA Small Business Relief Program. Funding was expanded by \$200,000 due to increased need and general enthusiasm for the program.

Communities Powered by **FORWARD**

Administering over \$700 million to communities across the nation



WASHINGTON COVID-19
IMMIGRANT RELIEF FUND



Transforming lives

FORWARD is collaborating with the Washington State Department of Social and Health Services and a network of immigrant-led organizations to implement a \$300M stipend program for immigrants in the state of Washington who did not receive support from previous COVID relief programs.



FORWARD distributed \$14 million to about 1,000 small businesses on behalf of the Washington State Department of Agriculture to support four sectors: wineries/breweries, shellfish farmers, farmers markets, and agri-tourism.

Affiliate Agenda



Washington State Association of Local
Public Health Officials

Monday, November 14

1:00pm - 5:00pm **Affiliate Meeting** Bellevue

Tuesday, November 15

8:15am - 9:00am **BOD Meeting** Bellevue

9:00am - 12:00pm **Affiliate Meeting**



Washington State Association of
County Engineers

Monday, November 14

1:00pm - 3:00pm **WSACE Business Meeting - Roll Call & Reports** Grand 1

3:00pm - 3:30pm **Networking Break**Grand Prefunction

3:30pm - 4:30pm **NACE Director - NACE Report**

4:30pm - 5:30pm **WSACE Board Meeting - Legislative Priorities, Budget Update, 2023
Schedule of Events**

Tuesday, November 15

9:45am - 10:45am **WSACE Tech Session: State Highway Access Update** Grand 1

12:00pm - 1:15pm **JTC/WSACE Lunch** Grand 1

1:15pm - 5:00pm **King County Site Visit and Tech Session: King County Roads Equity
Journey Presentation and Discussion** Off-Site

Wednesday, November 16

8:30am - 9:30am **WSACE Tech Session: Emerging Technology
in Public Works** Grand 1

1:15pm - 2:15pm **WSACE Tech Session: Right-of-Way
Questions Answered** Grand 1

Serving Washington State since 1958



WCIF

Washington Counties
Insurance Fund



**WE'LL DO EVERYTHING BUT
REMIND YOUR KIDS
TO TAKE OUT THE GARBAGE.**

We are proud to sponsor
WSAC and always
welcome new partners.
Contact us to learn more:

Mary S. Evans
Director
Public Sector Solutions
425-814-7844
mevans4@wm.com

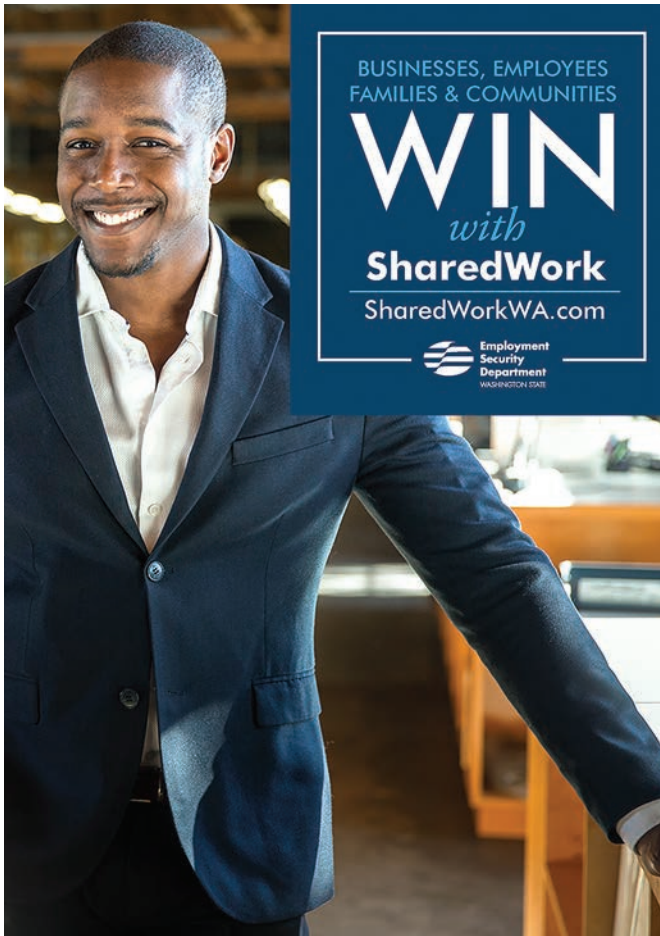

BUSINESSES, EMPLOYEES
FAMILIES & COMMUNITIES

WIN

with

SharedWork

SharedWorkWA.com



Employment
Security
Department
WASHINGTON STATE

Affiliate Agenda



Washington State Association of County
and Regional Planning Directors

Wednesday, November 16

9:00am - 9:05am	Welcome, Introductions, Review Agenda West Seattle
9:05am - 9:15am	Staff Report
9:15am - 9:30am	WSACRPD Business Meeting
9:30am - 10:50am	Legislative Panel
10:50am - 11:00am	Networking Break. Grand Prefunction
11:00am - 12:00pm	Net Ecological Gain – Joint Presentation with the Coastal Counties Caucus
12:00pm	Meeting Adjournment

Counties Coastal Caucus

Counties Coastal Caucus

Wednesday, November 16

10:00am - 10:05am	Call to Order, Welcome, Introductions & Approval of the Agenda Rainier
10:05am - 10:10am	Legislative Updates
10:10am - 11:00am	Floodplains by Design- County Partnerships for Integrated Flood Plain Management
11:00am - 12:00pm	Net Ecological Gain – Joint Presentation with the County and Regional Planning Directors
12:00pm	Meeting Adjournment

Notes

WSAC Officers and Staff

WSAC OFFICERS



President

Jamie Stephens
San Juan County Councilmember



First Vice President

Mary Kuney
Spokane County Commissioner



Second Vice President

Lisa Janicki
Skagit County Commissioner



Immediate Past President

Michael Largent
Whitman County Commissioner

WSAC STAFF

Eric Johnson
Executive Director

Administration and Finance

Bridget Lockling
*Director, Finance and
Administration*

Lynn Fiorillo-Lowe
*Operations and Support
Assistant*

Communications & Member Services

Tyler Melhart
*Graphic/Web Design
Manager*

Mitch Netzer
Communications Manager

Jessica Strozewski
Operations Coordinator

Policy and Legislative Relations

Jaime Bodden
*Managing Director,
Washington State Association
of Local Public Health
Officials (WSALPHO)*

Axel Swanson
*Managing Director,
Washington State Association
of County Engineers (WSACE)*

Travis Dutton
Policy Analyst

Chris Goodwin
FPHS Policy Advisor

Paul Jewell
Policy Director

Juliana Roe
Policy Director

Brianna Steere
FPHS Policy Advisor

Curtis Steinhauer
Policy Analyst

Mike Hoover
Policy Consultant

Program Services

Brynn Brady
*Program Consultant - Coastal
Caucus*

Court Stanley
*Program Consultant - Timber
Program*

Gold Sponsor



Washington State Department of **Commerce**

The Department of Commerce is the one agency in state government that touches every aspect of community and economic development: planning, infrastructure, energy, public facilities, housing, public safety and crime victims, international trade, business services and more. We work with local governments, businesses and civic leaders throughout the state to strengthen communities so all residents may thrive and prosper.

Mark Barkley
Assistant Director
360-522-3390
mark.barkley@commerce.wa.gov
commerce.wa.gov

Silver Sponsors

FORWARD

The FORWARD Platform is the leading integrated approach to administering government programs. FORWARD modernizes program administration by bringing together all the components, people, and technology to effectively run assistance programs by streamlining community outreach, online application portal, application intake and review, fraud prevention, payment processing, and reporting into a single workflow to securely and equitably administer critical resources to help communities thrive. Since 2020, FORWARD has been successfully administering over \$700M to communities across the nation, including rental assistance for low-income households, assistance grants for small businesses, direct cash assistance for struggling individuals, and workforce incentives.

Helen Hennighausen

Senior Manager of

Expansion & Inbound

helen.h@forwardplatform.com

forwardplatform.com



Washington Counties Insurance Fund (WCIF) is a public non-profit, member-run multiple employer trust established in 1958 by Washington State Association of Counties (WSAC). WCIF provides health and welfare benefits to Washington public employers and eligible non-profit entities.

Benefits are what we do BEST!

Bobby Jackson

Executive Director

360-292-4474

bobby@wcif.net

wcif.net

Bronze Sponsors

BUSINESSES, EMPLOYEES FAMILIES & COMMUNITIES

WIN *with* SharedWork

SharedWorkWA.com • 800-752-2500

SharedWork is an opt-in program and excellent business resource to help stabilize the operations of most businesses during temporary economic setbacks. Employers keep their workforce intact by temporarily reducing hours to save payroll costs and keep the business operating. SharedWork pays employees a prorated percentage of unemployment insurance benefits. Eligibility is open to most business and industries.

Rafael Colon

Business Outreach Manager

360-878-4088

rafael.colon@esd.wa.gov

esd.wa.gov/sharedwork



WM is the leading provider of comprehensive recycling and environmental services across the Pacific Northwest and North America. WM provides solid waste collection and disposal services for communities in every corner on Washington State.

Mary Evans

Area Director,

Public Sector Solutions

425-814-7844

mevans4@wm.com

wm.com

County Supporters



WASTE CONNECTIONS
Connect with the Future®

Waste Connections is one of the largest full-service provider of solid waste collection, providing non-hazardous solid waste collection, recycling and landfill disposal services to commercial, industrial, municipal and residential customers.

Jody Snyder
*Manager Governmental
Affairs – Western Region*
253-377-0362
jody.snyder@
wasteconnections.com
wasteconnections.com



Since 1993 Gordon Thomas Honeywell Government Relations (GTH) has provided lobbying to a broad array of clients, developing an unrivaled track record of success and reputation as Washington State's leading government relations firm.

Josh Weiss
State Lobbyist & Partner
360-561-3560
jweiss@gth-gov.com
wa.gth-gov.com



Sustainability in Action

Republic Services has a rich history of providing dependable recycling and waste services across the U.S., and today, we're a leader in the environmental services industry—partnering with our customers for a more sustainable world.

Steven Gilmore
*Municipal Relationship
Manager*
425-646-2533
sgilmore@republicservices.com
republicservices.com



WASHINGTON
REFUSE &
RECYCLING
ASSOCIATION

WRRA is an association of solid waste companies and professionals who have gathered to promote the private solid waste and recycling industry and our member companies. We provide members with general legal support, workshops, and representation before regulatory agencies and the Legislature.

Brad Lovaas
Executive Director
360-943-8859
brad@wrra.org
wrra.org

Exhibitors



Founded in 1933, the Association of Washington Cities (AWC) is a private, nonprofit, nonpartisan corporation that represents Washington's cities and towns through advocacy, education, and member pooling programs such as the Employee Benefits Trust, Drug & Alcohol Consortium, and GIS Consortium.

Terri Luther
*Marketing & Field
Service Coordinator*
360-584-7659
terril@awcnet.org
wacities.org



Founded in 2007, Beacon Economics entered the spotlight as one of the earliest and most adamant forecasters of the subprime mortgage market meltdown – and as one of a handful of organizations to stand against the tide and correctly calculate the depth of the global financial and economic crisis that followed.

Kristen Lovell
Strategic Partnerships Manager
kristen@beaconecon.com
beaconecon.com



The BuyBoard National Purchasing Cooperative is a comprehensive purchasing tool for local governments to lessen the purchasing burden by driving down costs and making procurement more efficient through competitively procured contracts and documented audit trail.

Doug Williams
Regional Director
425-260-4423
douglas.williams@buyboard.com
buyboard.com



A liquidity data tool for the public sector & higher Ed to execute borrowing, investing, and cash management decisions with more confidence and greater ease. We provide a pure and independent perspective on making certain every dollar you have is being put to work efficiently, every day.

Kyle Metcalfe
Business Development Officer
484-484-0311 x705
kjm@threeplusone.us
threeplusone.us

Exhibitors



We work with thousands of local government leaders to deliver technology that enables municipalities to optimize the experiences they deliver to residents. Over 7,500 local governments use our solutions when serving their 340 million residents. We deliver the industry's only Civic Experience Platform.

Karen Bond
Account Executive
785-789-4269
karen.bond@civicplus.com
civicplus.com

EMERGENT[®]

Emergent BioSolutions is a global life sciences company dedicated to one simple mission—to protect and enhance life. We develop, manufacture, and deliver a portfolio of medical countermeasures for biological and chemical threats as well as emerging infectious diseases.

Miae Aramori
Director, Community Health Solutions
206-612-8646
aramorim@ebsi.com
emergentbiosolutions.com



FLEET MANAGEMENT

Fleet management companies like Enterprise Fleet Management, have the infrastructure and partnerships in place to help businesses scale their vehicle needs, ultimately reducing fleet costs, known as the Total Cost of Ownership.

Laura Clarke
Sr. Account Executive
559-360-0801
laura.s.clarke@efleets.com
efleets.com



InQuik Bridges manufactures an innovative modular system to accelerate bridge construction that enables counties to deliver concrete bridge projects faster, with reduced risk and potential cost savings.

Steve Noble
Business Development
720-800-3388
steve.noble@inquikbridge.com
inquikbridge.com

Exhibitors



MRSC helps local governments across Washington better serve their communities by providing personalized legal and policy guidance, online and in-person training, extensive web-based and electronic resources, and regular information about emerging issues and trends.

Leah LaCivita
Communications Coordinator
206-625-1300 x118
llacivita@mrsc.org
mrsc.org



NACo provides members with a united, non-partisan voice in Washington to drive federal policy that supports county governments and fights unfunded mandates. NACo membership delivers value to county officials and staff through countless networking and learning opportunities at events and committees.

Kim Hall
Director of Membership
202-942-4221
khall@naco.org
naco.org



Nationwide provides retirement solutions, service, and planning for public sector employees.

Chelsea Walters
Retirement Specialist
253-442-4589
pearcc1@nationwide.com
nrsforu.com



PaintCare Inc., a non-profit 501(c)(3) organization, represents paint manufacturers (paint producers) to plan and operate paint stewardship programs in U.S. states and jurisdictions that pass paint stewardship laws.

Kim Harless
OR & WA
Program Coordinator
360-450-1639
kharless@paint.org
paintcare.org

Exhibitors

RENTACRATE®

Commercial office moving and rental of commercial moving equipment.

Jay Arcarese
Director of Sales
206-383-5738
jarcarese@rentacrate.com
rentacrate.com/pages/commercial



We are an insurance archaeology firm. That means we help property owners find ways to pay for environmental pollution cleanup using historical insurance policies. We call these long-lost policies “hidden assets” because they are a financial resource for an environmental liability that’s not budgeted for.

Benjamin Pariser
Principal
206-963-4818
ben@restorical.com
restorical.com



StructureCraft

StructureCraft engineers and builds beautiful and efficient exposed timber and hybrid structures, bringing the old-world tradition of master craftsmen to the new world of high-tech construction.

Drew Willms
Business Development Engineer
604-557-6279
dwillms@structurecraft.com
structurecraft.com



United States
Department of
Agriculture

Rural Development

Federal Agency featuring Single Family, Community, Business & Cooperative, Utility & Telecom Programs
Loans & Grants in Rural Communities

Helen Price Johnson
State Director
360-704-7715
helen.pricejohnson@usda.gov
rd.usda.gov/wa

Exhibitors



The Voluntary Stewardship Program is a program of the Washington State Conservation Commission that is an alternative to a county's critical area ordinance, that seeks to protect critical areas while maintaining agriculture viability.

Bill Eller

*Voluntary Stewardship
Program Coordinator*
509-385-7512
beller@scc.wa.gov
scc.wa.gov/vsp



The Correctional Options Services Department was established by WASPC in 1991. Overseen by the WASPC executive board. WASPC Correctional Options Services offers electronic monitoring equipment (EHM) and services for alternatives to incarceration.

Raeanne Myers

Manager
360-486-2407
rmyers@waspc.org
waspc.org



WRCIP is a member-driven and -owned insurance program. As an industry leader in both insurance and risk management, our team is focused on delivering customizable results. We strive to provide our clients with best-in-class service, so they can focus on what is most important – their county.

Melissa Swanson

*Administrative Assistant
to Sales & Production*
509-754-2027
mswanson@chooseclear.com
chooseclear.com



Washington State Department of
Labor & Industries

Return to Work Incentives - No one wants to see a worker go through an illness. When it happens, the first few days after an injury are critical. Being prepared will save your business time and money. Learn how employers are using light-duty to control their insurance costs while receiving cash-back refunds.

Joyce Gorski

Outreach
360-870-4920
joyce.gorski@lni.wa.gov
lni.wa.gov

THANK YOU SPONSORS & EXHIBITORS



Washington State
Department of
Commerce

FORWARD



BUSINESSES, EMPLOYEES FAMILIES & COMMUNITIES
WIN *with* **SharedWork**
SharedWorkWA.com • 800-752-2500



EMERGENT

